

This document is the property of Amphenol Corporation and is delivered on the express condition that it is not to be disclosed, reproduced or used, in whole or in part, for manufacture or sale by anyone other than Amphenol Corporation without its prior consent, & that no right is granted to disclose or to use any information in this document.

CUSTOMER DRAWING

REVISIONS				
SYM	ECN	DESCRIPTION	DATE	APPROVED
1	CDXXXX	FIRST RELEASE	Feb.22,2019	YH
2	CDXXXX	update the model	May.20,2019	YH

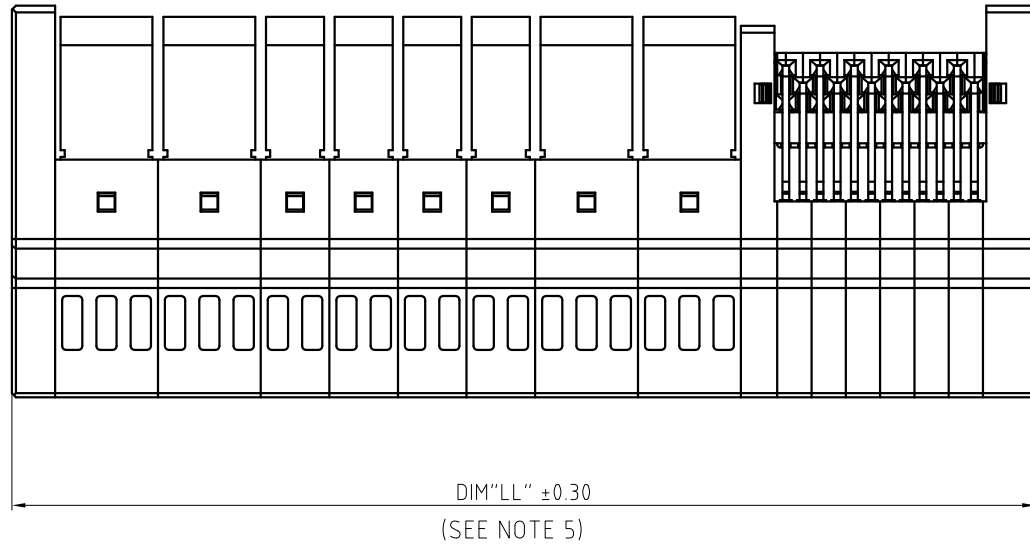
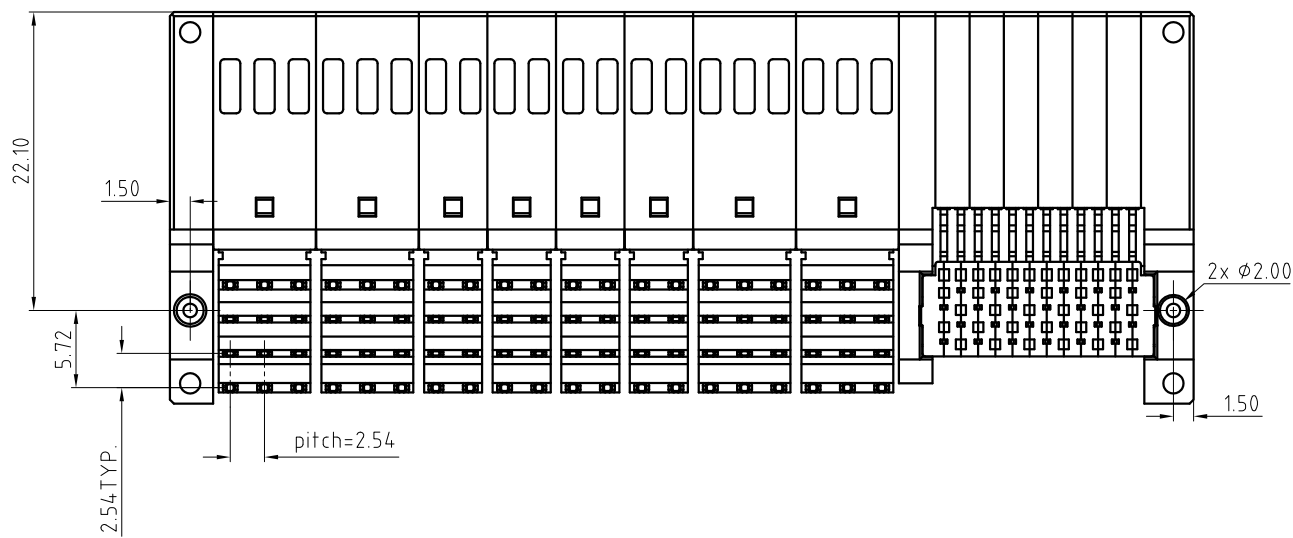
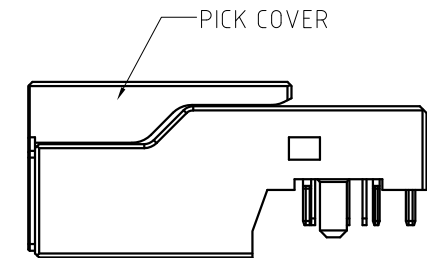
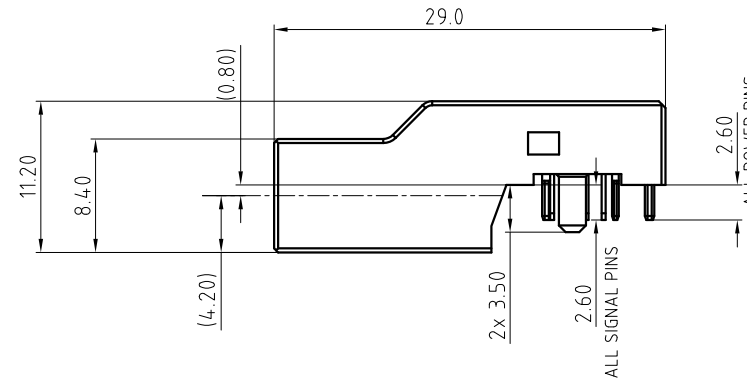
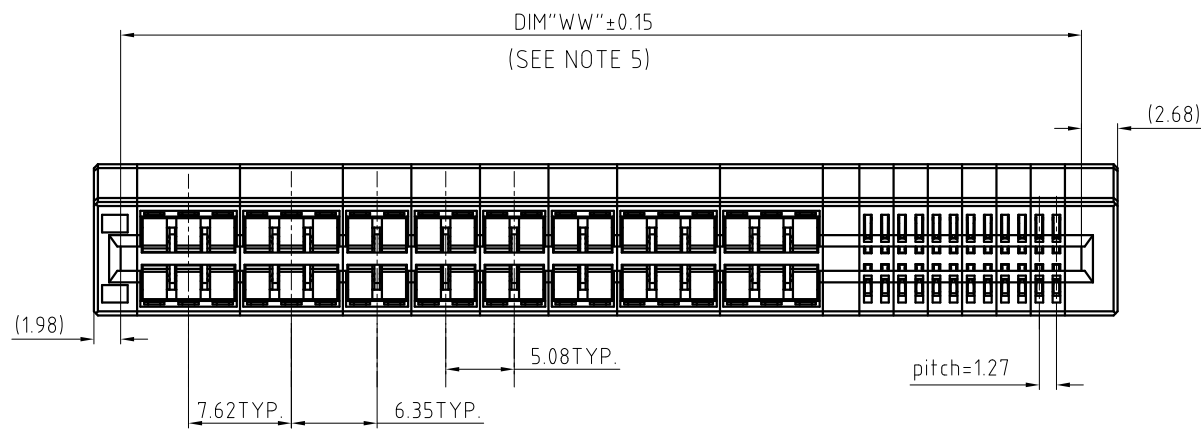

TABLE A:

VARIABLE	"PP"	"SS"	DIM"LL" (CONNECTOR WIDTH)	DIM"WW" (WINDOW WIDTH)
VALUE	POWER PIN COUNT	SIGNAL PIN COUNT	"PP"×1.27+"SS"×0.635+9.8	"PP"×1.27+"SS"×0.635+5.14



UNLESS OTHERWISE SPECIFIED TOLERANCES		APPROVAL		DATE		Amphenol	
U.S. METRIC		DRAWN	Brade.Zou	May.20,2019			
.X +/-	0.50	CHECKED					
.XX +/-	0.25	APPROVED				TITLE	
.XXX +/-	0.15			DRAWING FILE :		XXP+XXS RA Coplanar, Trough hole High Power Gold-Finger Connector	
FRACTIONS +/-				Internal\DRAWING\HPG\C HPGXXPXXSCTXXXX		SIZE	
ANGLES +/-	2°			ANGLE OF PROJECTION		DRAWING NO.	
FOR MATERIALS AND FINISHES SEE NOTES				REMOVE SHARP EDGES		A3	
DIMENSIONS				DIMENSIONS		C HPG-XXP-XXS-C-T-XX-X-X	
U.S.	INCHES			SCALE		REV.	
(METRIC)	(mm)			NONE		2	
				SHEET 1 OF 4			

This document is the property of Amphenol Corporation and is delivered on the express condition that it is not to be disclosed, reproduced or used, in whole or in part, for manufacture or sale by anyone other than Amphenol Corporation without its prior consent, & that no right is granted to disclose or to use any information in this document.

REVISIONS				
SYM	ECN	DESCRIPTION	DATE	APPROVED
		SEE SHEET 1		

CUSTOMER DRAWING

RECOMMENDED PCB FOOT PRINT
(VIEW FROM COMMONENT SIDE)

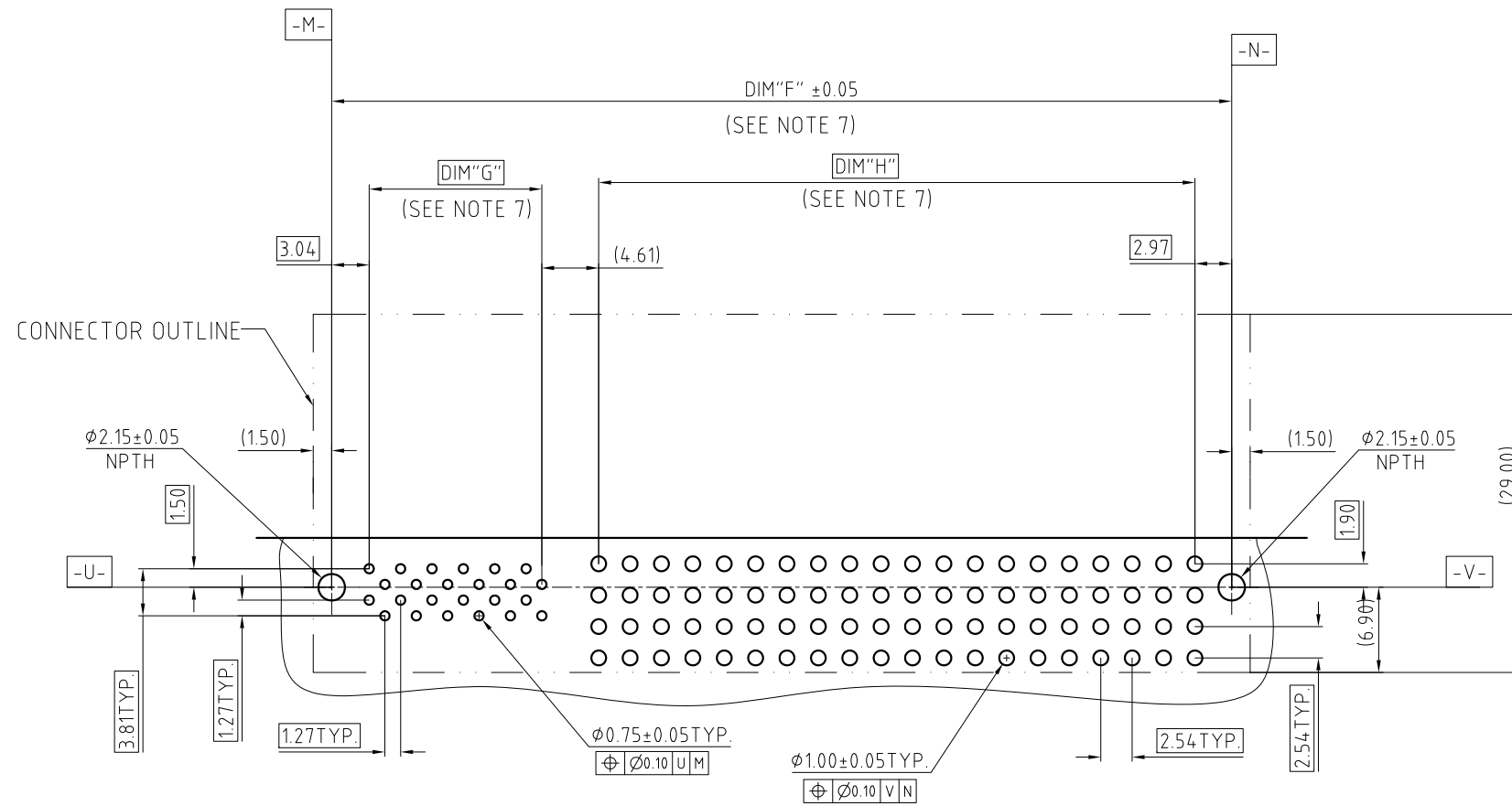

TABLE C:

VARIABLE	"PP"	"SS"	DIM "F"	DIM "G"	DIM "H"
VALUE	POWER PIN COUNT	SIGNAL PIN COUNT	"PP"×1.27+"SS"×0.635+6.8	"SS"×0.635-1.27	"PP"×1.27-2.54

UNLESS OTHERWISE SPECIFIED TOLERANCES U.S. METRIC .X +/- 0.25 .XX +/- 0.15 .XXX +/- 0.05 FRACTIONS +/- ANGLES +/- 2° FOR MATERIALS AND FINISHES SEE NOTES REMOVE SHARP EDGES DIMENSIONS — U.S. — INCHES (METRIC) (mm)	APPROVAL DRAWN Brade.Zou CHECKED APPROVED	DATE May.20,2019	<h2>Amphenol</h2>	
	DRAWING FILE : Internal\DRAWING\HPG\C HPGXXPXXSCTXXXX			TITLE XXP+XXS RA Coplanar, Trough hole High Power Gold-Finger Connector
	ANGLE OF PROJECTION 			SIZE DRAWING NO. REV. A3 C HPG-XXP-XXS-C-T-XX-X-X 2
	DIMENSIONS — U.S. — INCHES (METRIC) (mm)			SCALE NONE SHEET 3 OF 4

This document is the property of Amphenol Corporation and is delivered on the express condition that it is not to be disclosed, reproduced or used, in whole or in part, for manufacture or sale by anyone other than Amphenol Corporation without its prior consent, & that no right is granted to disclose or to use any information in this document.

REVISIONS				
SYM	ECN	DESCRIPTION	DATE	APPROVED
		SEE SHEET 1		

CUSTOMER DRAWING

POWER PIN COUNT VIEW

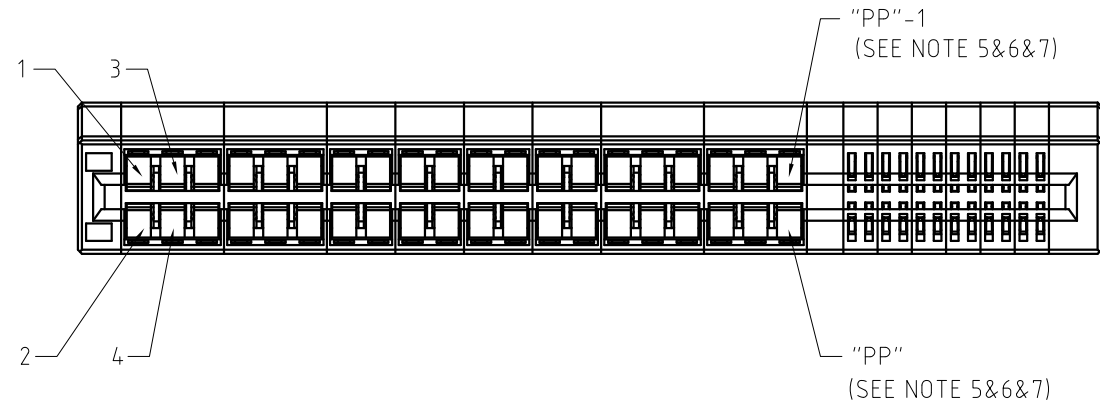

SIGNAL PIN COUNT VIEW

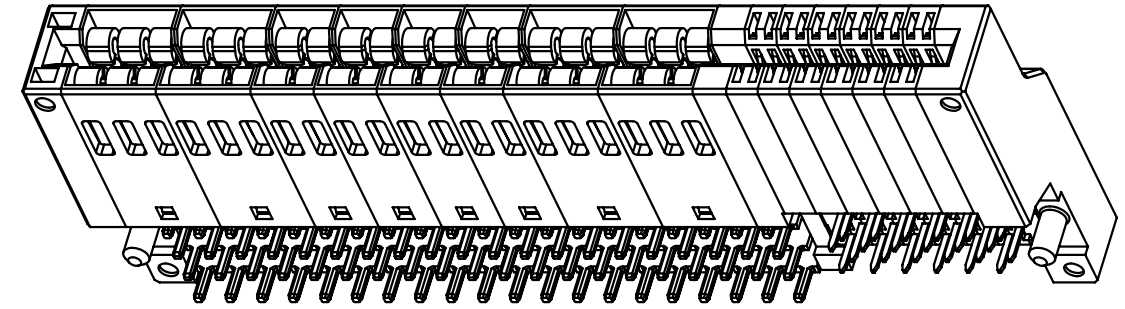
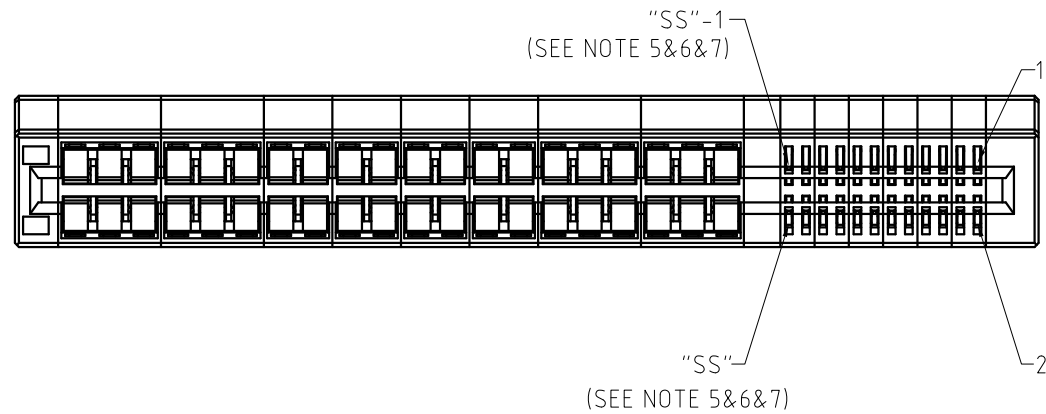

NOTE:

- MATERIAL:
HOUSING: HIGH TEMPERATURE THERMOPLASTIC, BLACK UL94-V0, HALOGEN FREE.
CONTACT: COPPER ALLOY
- PLATING:
MATING AREA: SEE PN SYSTEM
SOLDER AREA: TIN OVER Ni UNDERPLATED.
UNDER PLATED: 1.27um MIN. Ni UNDERPLATED ALL AREA.
- CARD THICKNESS: 1.60MM.
- PCB THICKNESS: 2.40MM
- VARIABLE DIMENSION OF CONNECTOR SHOW IN TABLE A (IN SHEET 1)
- VARIABLE DIMENSION OF MATING CARD SHOW IN TABLE B (IN SHEET 2)
- VARIABLE DIMENSION OF HOST BOARD SHOW IN TABLE C (IN SHEET 3)
- MATERIAL SHOULD BE FULFILLED AMPHENOL SEPC # SSN002;
FOR HALOGEN FREE PRODUCTS, ALSO NEED TO MEET S-SN-004.
- ORDER PN: REFER TO PN SYSTEM

PN SYSTEM:

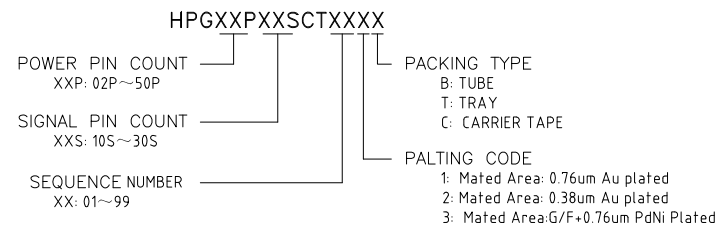

UNLESS OTHERWISE SPECIFIED TOLERANCES U.S. METRIC .X +/- 0.25 .XX +/- 0.15 .XXX +/- 0.05 FRACTIONS +/- ANGLES +/- 2° FOR MATERIALS AND FINISHES SEE NOTES REMOVE SHARP EDGES DIMENSIONS U.S. INCHES (METRIC) (mm)	APPROVAL DRAWN Brade.Zou CHECKED APPROVED	DATE May.20,2019	Amphenol TITLE XXP+XXS RA Coplanar, Trough hole High Power Gold-Finger Connector		
	DRAWING FILE : Internal\DRAWING\HPG\C HPGXXPXXSCTXXXX				SIZE DRAWING NO. A3 C HPG-XXP-XXS-C-T-XX-X-X
	ANGLE OF PROJECTION 		SCALE NONE	SHEET 4 OF 4	
				SHEET 4 OF 4	