

This document is the property of Amphenol Corporation and is delivered on the express condition that it is not to be disclosed, reproduced or used, in whole or in part, for manufacture or sale by anyone other than Amphenol Corporation without its prior consent, & that no right is granted to disclose or to use any information in this document.

# CUSTOMER DRAWING

REVISIONS				
SYM	ECN	DESCRIPTION	DATE	APPROVED
1	CDXXXX	FIRST RELEASE	Feb.22,2019	YH
2	CDXXXX	update the model	May.20,2019	YH

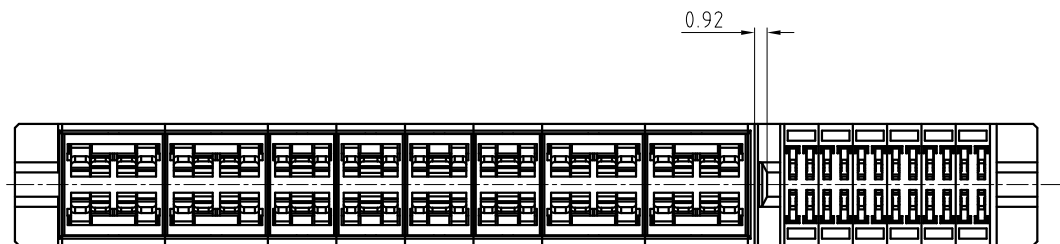
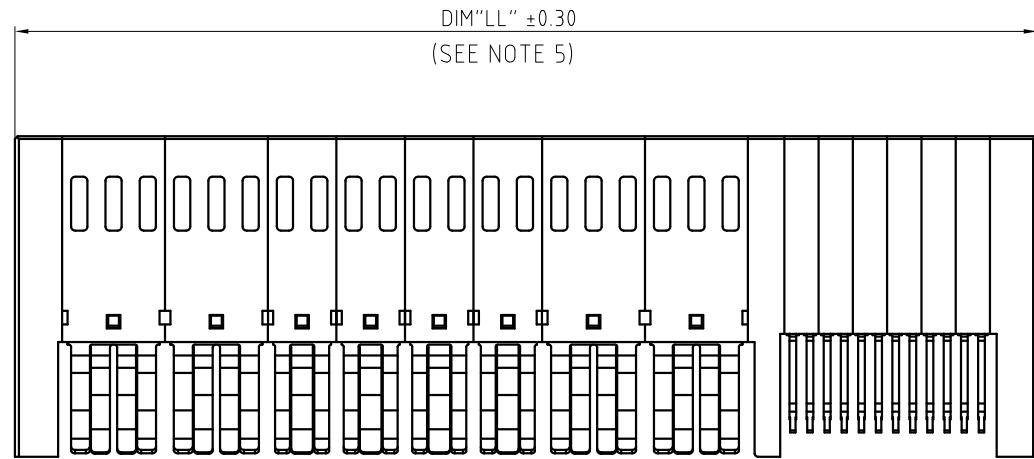
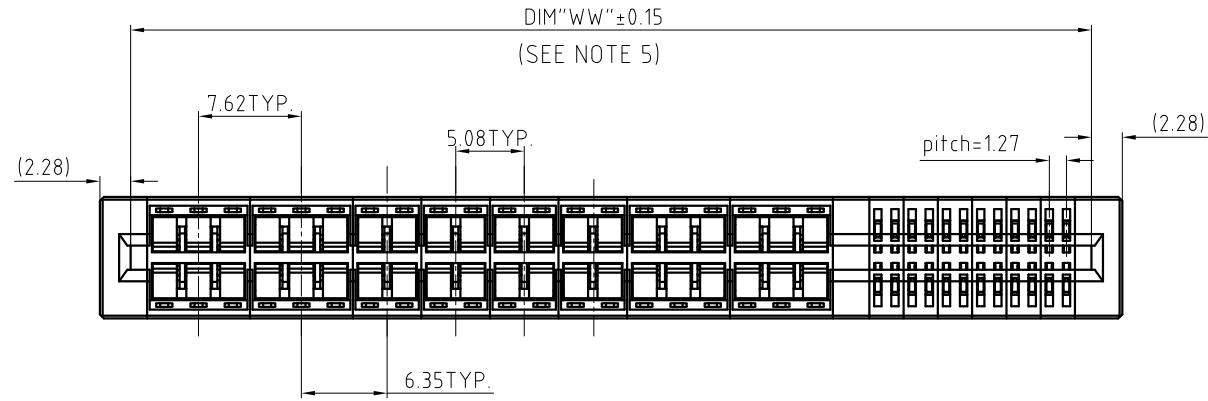
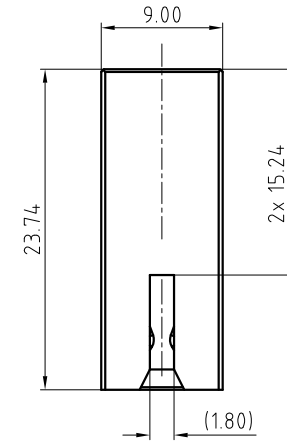

TABLE A:

VARIABLE	"PP"	"SS"	DIM "LL" (CONNECTOR WIDTH)	DIM "WW" (WINDOW WIDTH)
VALUE	POWER PIN COUNT	SIGNAL PIN COUNT	"PP"×1.27+"SS"×0.635+9.7	"PP"×1.27+"SS"×0.635+5.14



UNLESS OTHERWISE SPECIFIED <b>TOLERANCES</b> U.S. METRIC .X +/- 0.50 .XX +/- 0.25 .XXX +/- 0.15 FRACTIONS +/- ANGLES +/- 2° FOR MATERIALS AND FINISHES SEE NOTES REMOVE SHARP EDGES DIMENSIONS U.S. INCHES (METRIC) (mm)	APPROVAL DRAWN: Brade.Zou CHECKED APPROVED	DATE May.20,2019	<b>Amphenol</b>
	DRAWING FILE : Internal\DRAWING\HPG\C HPGXXPXXSSXXXX	TITLE XXP+XXS Straddle Mount High Power Gold-Finger Connector	
	ANGLE OF PROJECTION 	SIZE: A3 SCALE: NONE	DRAWING NO.: C HPG-XXP-XXS-S-S-XX-X-X SHEET 1 OF 4
	REV. 2		

This document is the property of Amphenol Corporation and is delivered on the express condition that it is not to be disclosed, reproduced or used, in whole or in part, for manufacture or sale by anyone other than Amphenol Corporation without its prior consent, & that no right is granted to disclose or to use any information in this document.

REVISIONS				
SYM	ECN	DESCRIPTION	DATE	APPROVED
		SEE SHEET 1		

# CUSTOMER DRAWING

## RECOMMENDED MATTING CARD LAYOUT

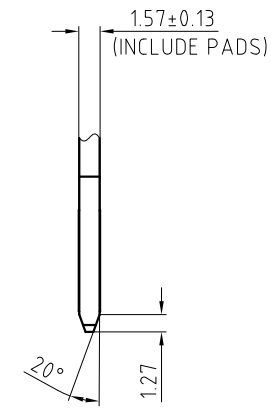
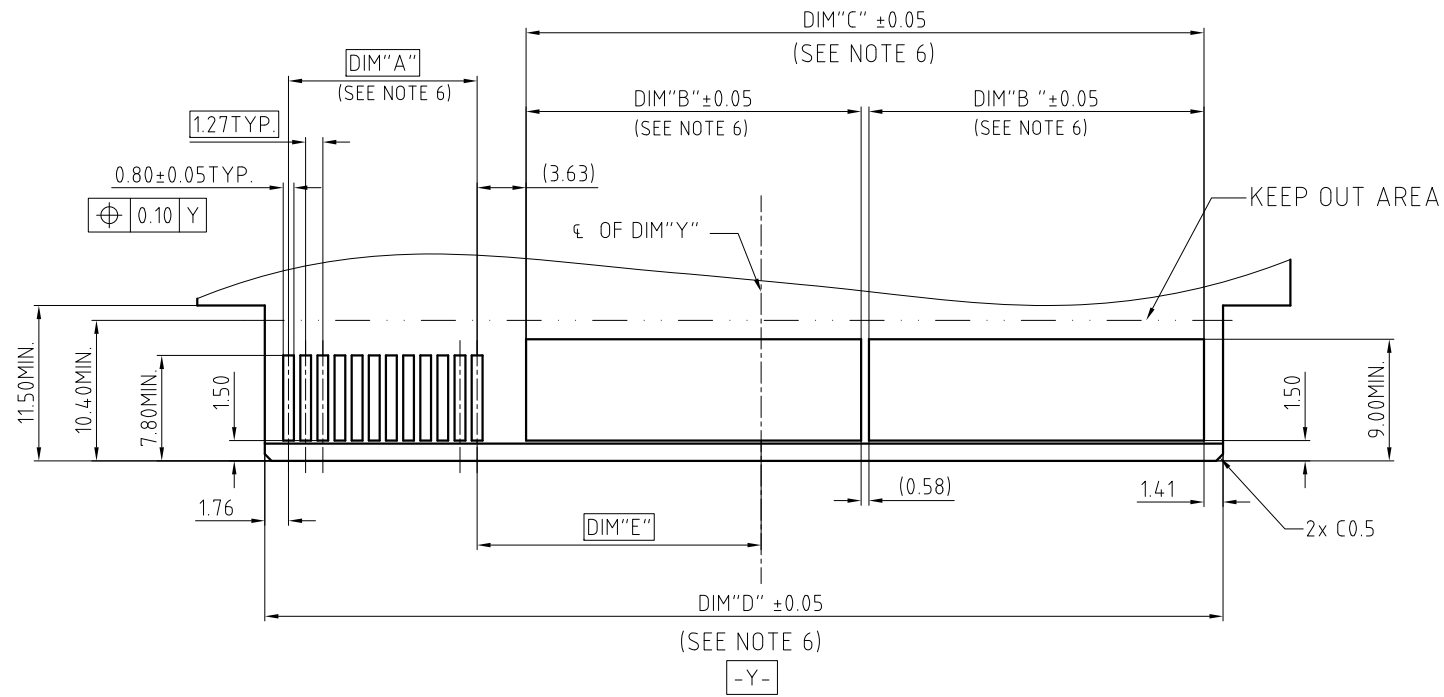

TABLE B:

VARIABLE	"PP"	"SS"	DIM "A"	DIM "B"	DIM "C"	DIM "D"	DIM "E"
VALUE	POWER PIN COUNT	SIGNAL PIN COUNT	"SS" × 0.635 - 1.27	"PP" × 0.635 - 0.58	"PP" × 1.27 - 0.58	"PP" × 1.27 + "SS" × 0.635 + 4.94	"PP" × 0.635 - 4.37



UNLESS OTHERWISE SPECIFIED TOLERANCES		APPROVAL		DATE		Amphenol	
U.S. METRIC		DRAWN	Brade.Zou	May.20,2019			
.X +/-	0.25	CHECKED		APPROVED			
.XX +/-	0.15	DRAWING FILE :		TITLE			
.XXX +/-	0.05	Internal\DRAWING\HPG\C HPGXXPXXSSSSXXX		XXP+XXS Straddle Mount			
FRACTIONS +/-		ANGLE OF PROJECTION		High Power Gold-Finger Connector			
ANGLES +/-	2°	REMOVE SHARP EDGES		SIZE	DRAWING NO.	REV.	
FOR MATERIALS AND FINISHES SEE NOTES		DIMENSIONS		A3	C HPG-XXP-XXS-S-S-XX-X-X	2	
REMOVE SHARP EDGES		- U.S. - INCHES		SCALE	NONE	SHEET 2 OF 4	
		(METRIC) (mm)					

This document is the property of Amphenol Corporation and is delivered on the express condition that it is not to be disclosed, reproduced or used, in whole or in part, for manufacture or sale by anyone other than Amphenol Corporation without its prior consent, & that no right is granted to disclose or to use any information in this document.

REVISIONS				
SYM	ECN	DESCRIPTION	DATE	APPROVED
		SEE SHEET 1		

# CUSTOMER DRAWING

## RECOMMENDED MOTHER BOARD LAYOUT

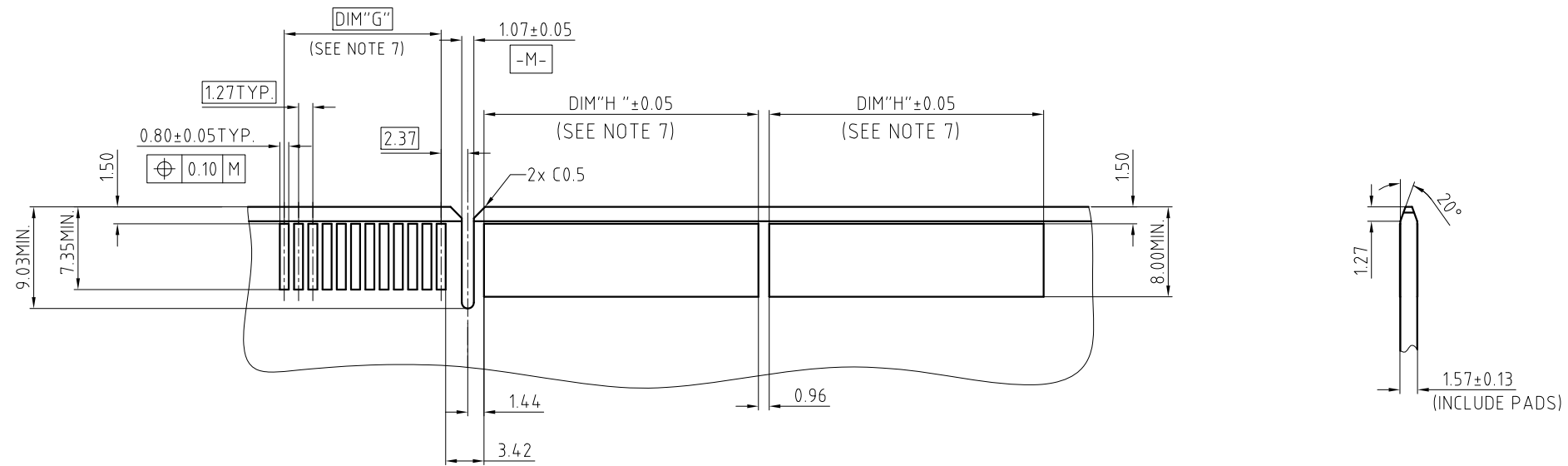

TABLE C:

VARIABLE	"PP"	"SS"	DIM"G"	DIM"H"
VALUE	POWER PIN COUNT	SIGNAL PIN COUNT	"SS"×0.635-1.27	"PP"×0.635-0.96



UNLESS OTHERWISE SPECIFIED <b>TOLERANCES</b> U.S. METRIC .X +/- 0.25 .XX +/- 0.15 .XXX +/- 0.05 FRACTIONS +/- ANGLES +/- 2° FOR MATERIALS AND FINISHES SEE NOTES REMOVE SHARP EDGES DIMENSIONS U.S. INCHES (METRIC) (mm)	APPROVAL DRAWN Brade.Zou CHECKED APPROVED	DATE May.20,2019	<b>Amphenol</b>  TITLE XXP+XXS Straddle Mount High Power Gold-Finger Connector
	DRAWING FILE : Internal\DRAWING\HPG\C HPGXXPXXSSSSXXX		
	ANGLE OF PROJECTION 		
	SIZE <b>A3</b>	DRAWING NO. C HPG-XXP-XXS-S-S-XX-X-X	
SCALE NONE		SHEET 3 OF 4	

This document is the property of Amphenol Corporation and is delivered on the express condition that it is not to be disclosed, reproduced or used, in whole or in part, for manufacture or sale by anyone other than Amphenol Corporation without its prior consent, & that no right is granted to disclose or to use any information in this document.

REVISIONS				
SYM	ECN	DESCRIPTION	DATE	APPROVED
		SEE SHEET 1		

# CUSTOMER DRAWING

POWER PIN COUNT VIEW

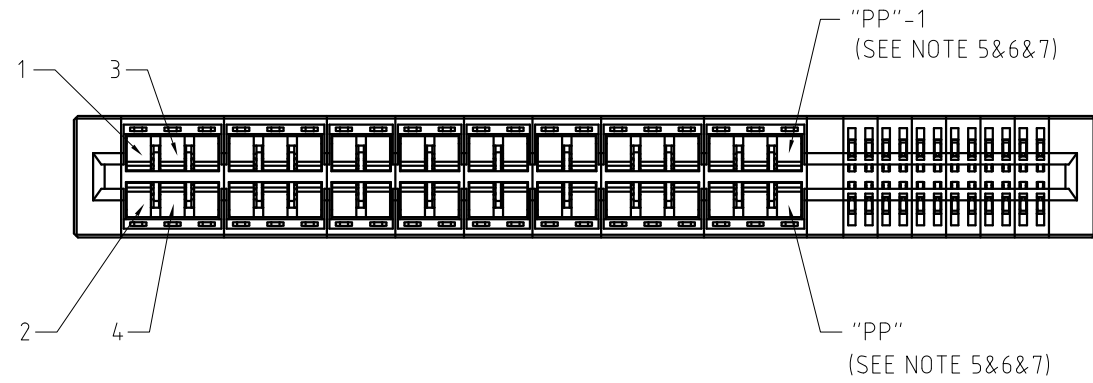

SIGNAL PIN COUNT VIEW

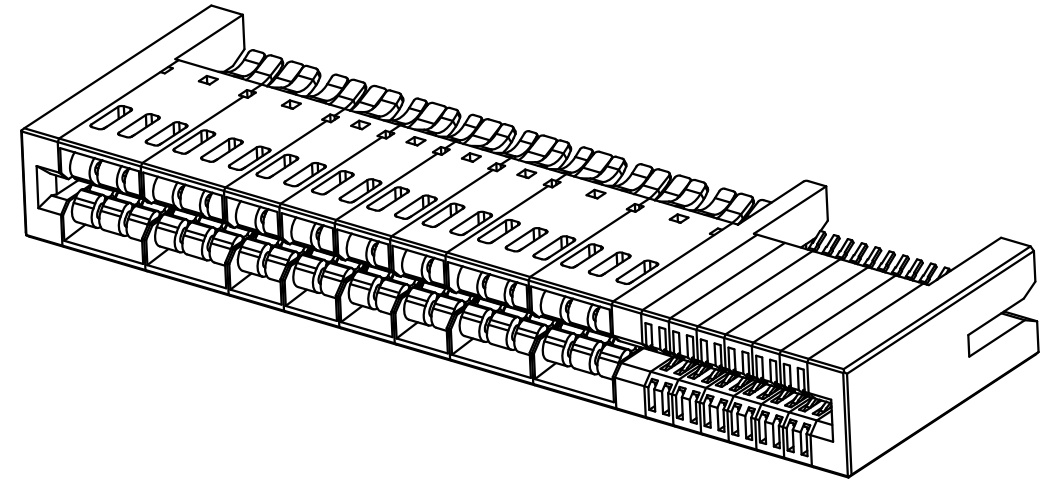
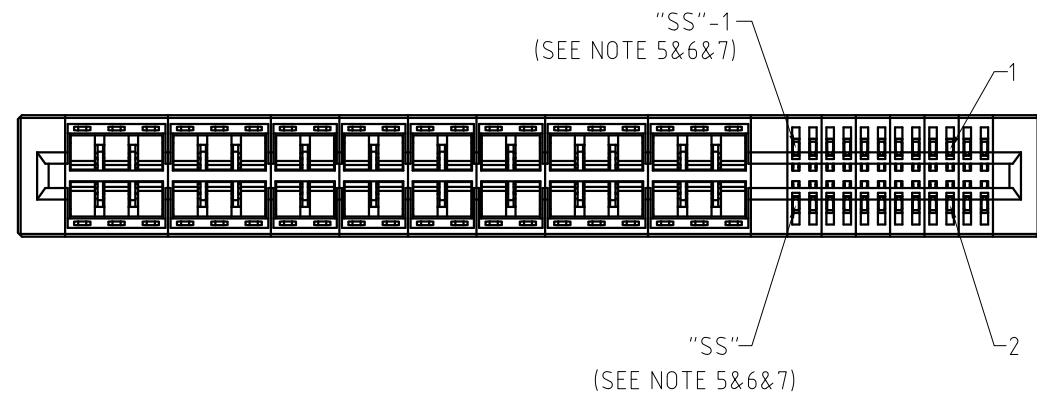

NOTE:

- MATERIAL:  
HOUSING: HIGH TEMPERATURE THERMOPLASTIC, BLACK UL94-V0, HALOGEN FREE.  
CONTACT: COPPER ALLOY
- PLATING:  
MATING AREA: SEE PN SYSTEM  
SOLDER AREA: TIN OVER Ni UNDERPLATED.  
UNDER PLATED: 1.27um MIN. Ni UNDERPLATED ALL AREA.
- CARD THICKNESS: 1.60MM.
- RECOMMENDED PCB THICKNESS: 1.60MM ~ 2.40MM
- VARIABLE DIMENSION OF CONNECTOR SHOW IN TABLE A (IN SHEET 1)
- VARIABLE DIMENSION OF MATING CARD SHOW IN TABLE B (IN SHEET 2)
- VARIABLE DIMENSION OF HOST BOARD SHOW IN TABLE C (IN SHEET 3)
- MATERIAL SHOULD BE FULFILLED AMPHENOL SEPC # SSN002;  
FOR HALOGEN FREE PRODUCTS, ALSO NEED TO MEET S-SN-004.
- ORDER PN: REFER TO PN SYSTEM

PN SYSTEM:

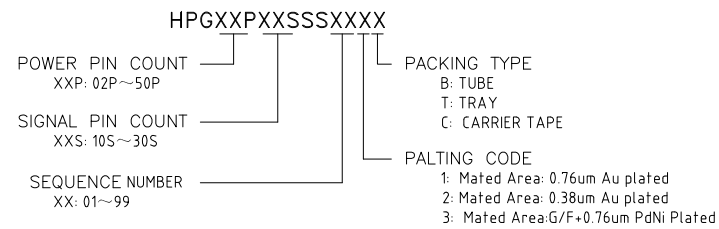

UNLESS OTHERWISE SPECIFIED <b>TOLERANCES</b> U.S.    METRIC .X    +/-    0.25 .XX   +/-    0.15 .XXX +/-    0.05 FRACTIONS +/- ANGLES +/-    2° FOR MATERIALS AND FINISHES SEE NOTES REMOVE SHARP EDGES DIMENSIONS — U.S. —    INCHES (METRIC)    (mm)	APPROVAL DRAWN    Brade.Zou CHECKED APPROVED	DATE May.20,2019	<b>Amphenol</b>	
	DRAWING FILE : Internal\DRAWING\HPG\C HPGXXPXXSSSXXXX	TITLE XXP+XXS Straddle Mount High Power Gold-Finger Connector		
	ANGLE OF PROJECTION 	SIZE    DRAWING NO. A3    C HPG-XXP-XXS-S-S-XX-X-X	REV. 2	
	SCALE    NONE    SHEET 4 OF 4			