

REVISIONS			
REV	DESCRIPTION, ECN, EAR NO.	DATE	APP'D
A	PROPOSAL	JUL29/14	L.CHAN
B	UPDATED SHIELD WITH NOTCH	APR 12/17	L.CHAN

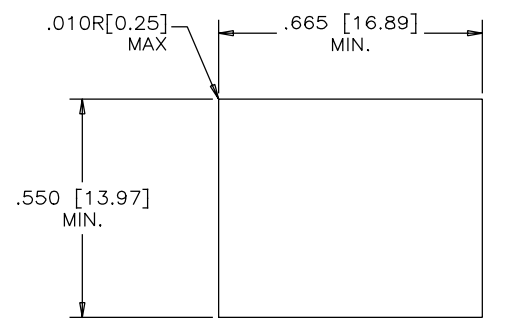

RECOMMENDED PANEL CUTOUT

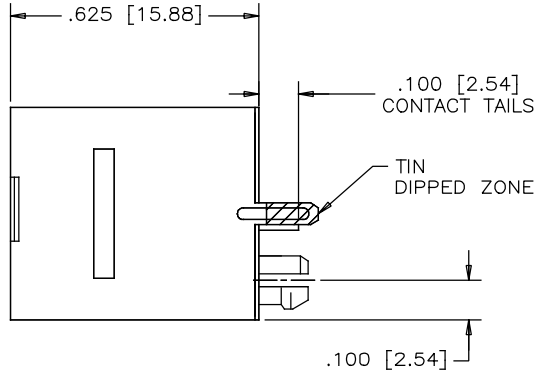
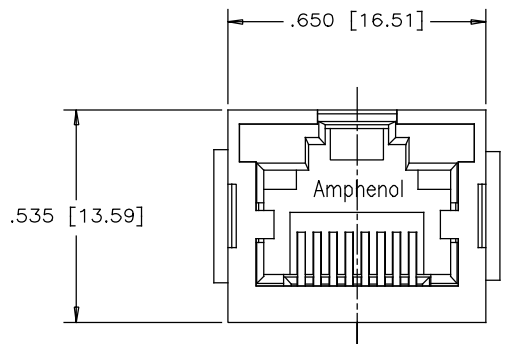
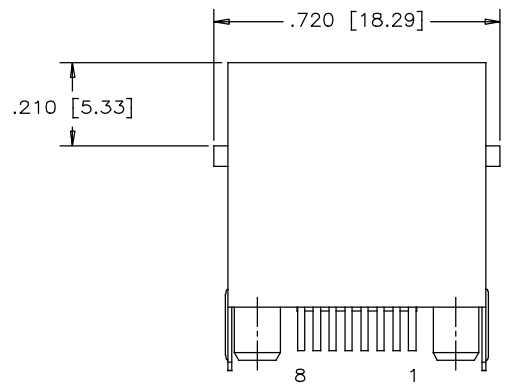

MATERIALS:

PLASTIC HOUSING: HIGH TEMPERATURE THERMOPLASTIC
FLAMMABILITY RATING UL 94V-0, COLOR: BLACK

CONTACTS: PHOSPHOR BRONZE
(FLAT) PLATING: 30 μ" [0.76 MICRONS]
MIN. GOLD ON MATING SURFACES.
50 μ" [1.27 MICRONS]
MIN. NICKEL UNDERPLATE
100 μ" [2.54 MICRONS]
MIN. MATTE TIN ON CONTACT TAILS.

SHIELD: STAINLESS STEEL WITH TIN DIPPED ON SOLDER TAILS.

RECOMMENDED SOLDERING TEMPERATURE:
WAVE SOLDERING TEMPERATURE AT 260°C MAXIMUM
FOR 5 SEC MAXIMUM.

AMPHENOL PART NUMBER: RJHSE-3380

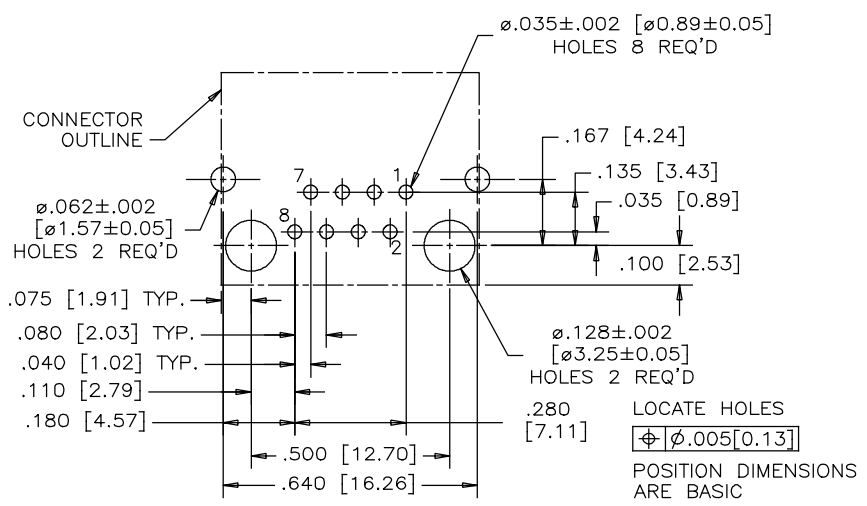

RECOMMENDED P.C.B. LAYOUT
(COMPONENT SIDE OF BOARD)

UNLESS SPECIFIED OTHERWISE		DRAWN <i>AMY.Z</i>	DATE <i>JUL29/14</i>	Amphenol Canada Corp. www.amphenolcanada.com
PRIMARY UNITS INCH	CHECKED <i>L.CHAN</i>	DATE <i>JUL29/14</i>	TITLE	
SECONDARY MILLIMETER	M.E. APP'D		SINGLE-PORT HIGH SPEED MODULAR JACK, VERTICAL MOUNT, 8P8C, SHIELDED, WITHOUT LED'S, - RoHS COMPLIANT	
REFERENCE IN PARENTHESES	Q.A. APP'D		DWG. NO. P-RJHSE-3380	
GENERAL TOLERANCES	DWG APPR.		REV B	
1 DECIMAL PLACE ±0.025	ENG. REL. NO.		CODE ID NO. 03554 [DWG SIZE: C] SCALE: <i>N/A</i> SHEET 1 OF 1	
2 DECIMAL PLACES ±0.020	REF.			
3 DECIMAL PLACES ±0.015	THIRD ANGLE PROJECTION			
ANGULAR DEGREES ±1.0°	DO NOT SCALE DRAWING			